

# SAN PEDRO MART RETAIL CONDO FOR SALE

*Lowest Priced Condo in the Mart! Seller Motivated!*



**Prime San Pedro Wholesale Mart Location**  
**1015 CROCKER STREET, UNIT P10, LOS ANGELES, CA 90021**

**MAJOR PROPERTIES**  
**REAL ESTATE**  
Commercial • Industrial • Residential

- Heart of the DTLA Fashion District
- San Pedro Wholesale Mart
- Parking Level Location Across From Escalator
- Great for Any Retail Fashion Use



Exclusively offered by

**Sion Khakshour**

Senior Associate

213.342.3384 office

213.210.7492 mobile

sion@majorproperties.com

Lic. 00697373

The information contained in this offering material is confidential and furnished solely for the purpose of a review by prospective Buyers or Lessees of the subject property and is not to be used for any other purpose or made available to any other person without the express written consent of Major Properties.

This Brochure was prepared by Major Properties. It contains summary information pertaining to the Property and does not purport to be all-inclusive or to contain all of the information that a prospective Buyer or Lessee may desire. All information is provided for general reference purposes only and is subject to change. The summaries do not purport to be complete or accurate descriptions of the full documents involved, nor do they constitute a legal analysis of such documents.

This information has been secured from sources we believe to be reliable. We make no representations or warranties, expressed or implied, as to the accuracy of the information. References to square footage or age are approximate. Recipient of this report must verify the information and bears all risk for any inaccuracies.

majorproperties.com

**MAJOR PROPERTIES**  
REAL ESTATE  
Commercial • Industrial • Residential

**1015 CROCKER STREET, UNIT P10  
LOS ANGELES, CA 90021**

## Property Details

Available Unit Area:	635± SF
Floor:	Parking Level
Rooms:	2
Restroom:	Yes
Parking Spaces:	One
Assessor's Parcel Number:	5132-030-010
Year Built:	2003
Zone:	LA M2
Type:	Commercial Condominium
Total Land Area:	52,213± SF

**SALE PRICE REDUCED! \$140,000 (\$220.47/SF)**

*Owner financing available with 25% down  
(Call broker for details)*

## Property Highlights

- Lowest priced retail condo in the mart!
- Located in the San Pedro Wholesale Mart
- Completely refurbished parking level unit
- 2 rooms with kitchen and restroom
- Located directly across from escalator
- Heart of the DTLA Fashion District
- Ideal for any retail fashion use
- Tenant controlled HVAC
- Located one block east of San Pedro Street and three blocks north of Pico Boulevard
- One-half mile north of the Santa Monica Freeway
- Heavy traffic area: 24,222 vehicles per day
- Transit Score: 88
- Walk Score: 74

# Interior Photos



# Plat Map

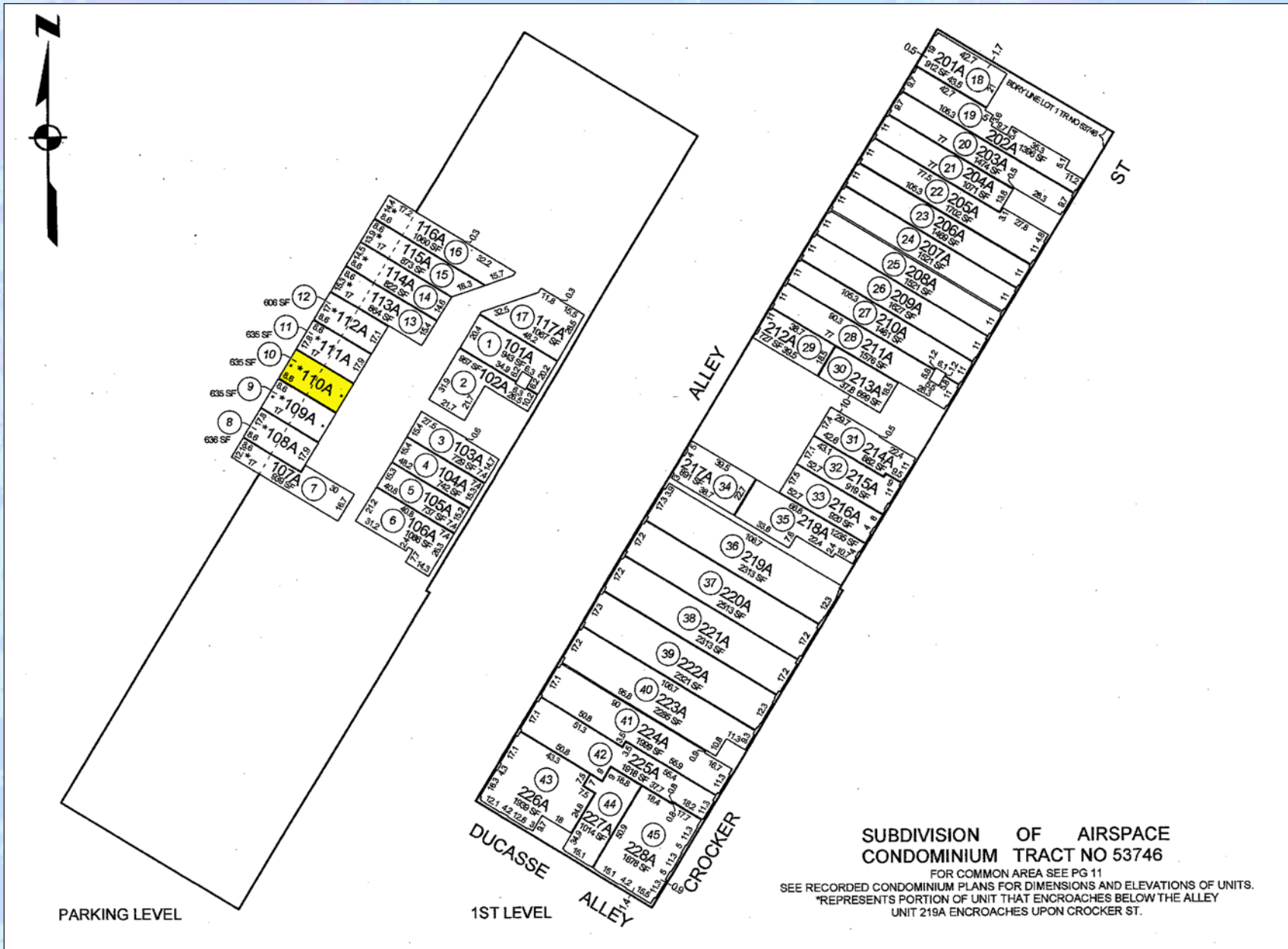

## SUBDIVISION OF AIRSPACE CONDOMINIUM TRACT NO 53746

FOR COMMON AREA SEE PG 11

SEE RECORDED CONDOMINIUM PLANS FOR DIMENSIONS AND ELEVATIONS OF UNITS.

\*REPRESENTS PORTION OF UNIT THAT ENCLOSES BELOW THE ALLEY

UNIT 219A ENCLOSES UPON CROCKER ST.

# San Pedro Wholesale Mart Aerial Photo



# Area Map

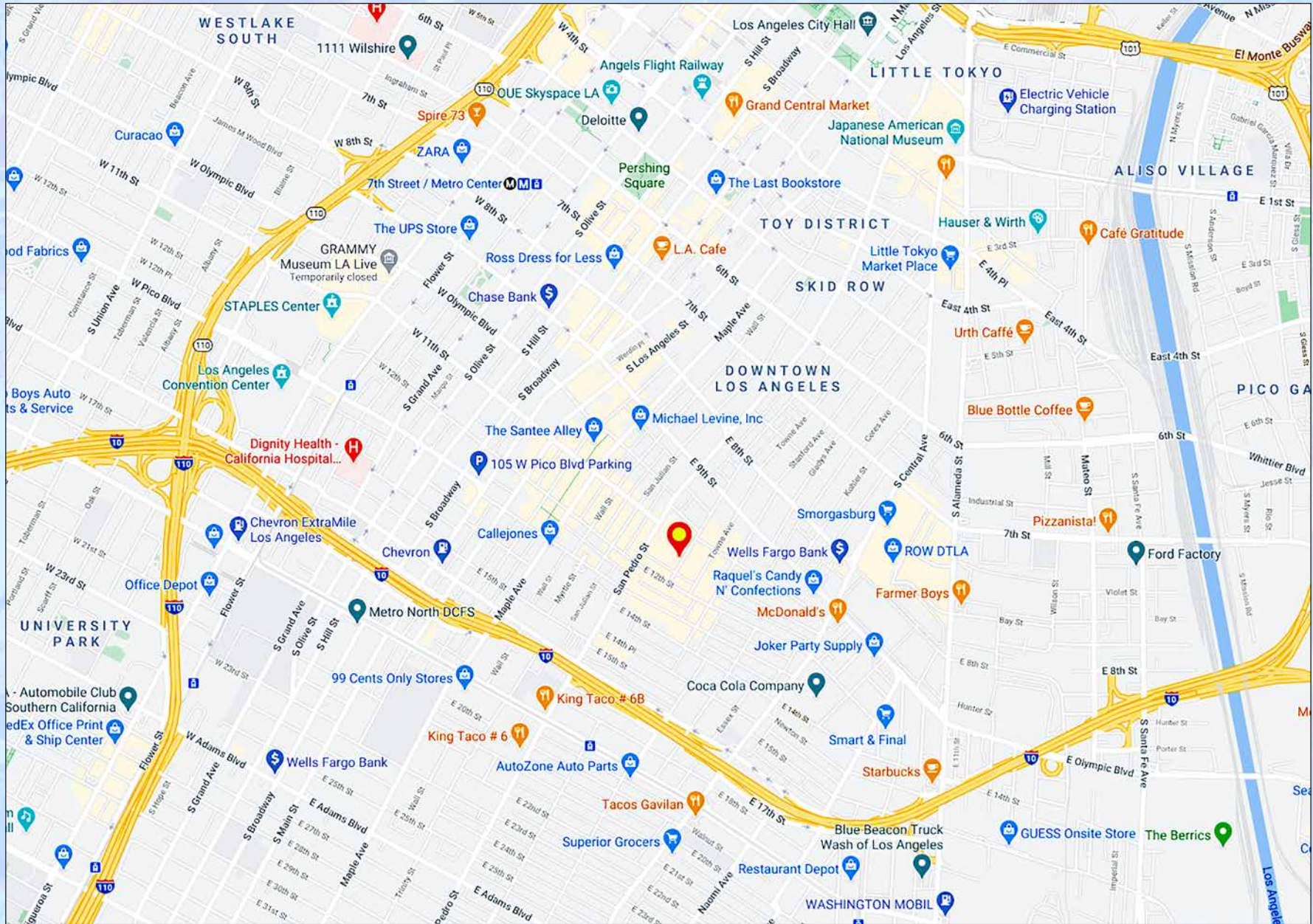

## San Pedro Wholesale Mart

1015 Crocker Street, Unit P10  
Los Angeles, CA 90021

635± SF Retail Condo  
Part of Larger Property

***Lowest Priced Condo in the Mart!***  
***\$140,000 (\$220.47 Per SF)***



Exclusively offered by

**Sion Khakshour**

Senior Associate

213.342.3384 office

213.210.7492 mobile

sion@majorproperties.com

Lic. 00697373

majorproperties.com

**MAJOR PROPERTIES**  
REAL ESTATE  
Commercial • Industrial • Residential