

SAN PEDRO MART RETAIL CONDO FOR SALE

Price Reduced! Lowest Priced Condo in the Mart!



Prime San Pedro Wholesale Mart Location
1015 CROCKER STREET, UNIT P10, LOS ANGELES, CA 90021

MAJOR PROPERTIES
REAL ESTATE
Commercial • Industrial • Residential

- Heart of the DTLA Fashion District
- San Pedro Wholesale Mart
- Parking Level Location Across From Escalator
- Great for Any Retail Fashion Use



Exclusively offered by

Sion Khakshour

Senior Associate

213.342.3384 office

213.210.7492 mobile

sion@majorproperties.com

Lic. 00697373

The information contained in this offering material is confidential and furnished solely for the purpose of a review by prospective Buyers or Lessees of the subject property and is not to be used for any other purpose or made available to any other person without the express written consent of Major Properties.

This Brochure was prepared by Major Properties. It contains summary information pertaining to the Property and does not purport to be all-inclusive or to contain all of the information that a prospective Buyer or Lessee may desire. All information is provided for general reference purposes only and is subject to change. The summaries do not purport to be complete or accurate descriptions of the full documents involved, nor do they constitute a legal analysis of such documents.

This information has been secured from sources we believe to be reliable. We make no representations or warranties, expressed or implied, as to the accuracy of the information. References to square footage or age are approximate. Recipient of this report must verify the information and bears all risk for any inaccuracies.

majorproperties.com



1015 CROCKER STREET, UNIT P10
LOS ANGELES, CA 90021

Property Details

Available Unit Area:	635± SF
Floor:	Parking Level
Rooms:	2
Restroom:	Yes
Parking Spaces:	One
Assessor's Parcel Number:	5132-030-010
Year Built:	2003
Zone:	LA M2
Type:	Commercial Condominium
Total Land Area:	52,213± SF

PRICE REDUCED!

~~\$140,000~~ \$125,000 (\$196.85/SF)

*Owner financing available with 25% down
(Call broker for details)*

Property Highlights

- Lowest priced retail condo in the mart!
- Located in the San Pedro Wholesale Mart
- Completely refurbished parking level unit
- 2 rooms with kitchen and restroom
- Located directly across from escalator
- Heart of the DTLA Fashion District
- Ideal for any retail fashion use
- Tenant controlled HVAC
- Located one block east of San Pedro Street and three blocks north of Pico Boulevard
- One-half mile north of the Santa Monica Freeway
- Heavy traffic area: 24,222 vehicles per day
- Transit Score: 88
- Walk Score: 74

Interior Photos



Plat Map

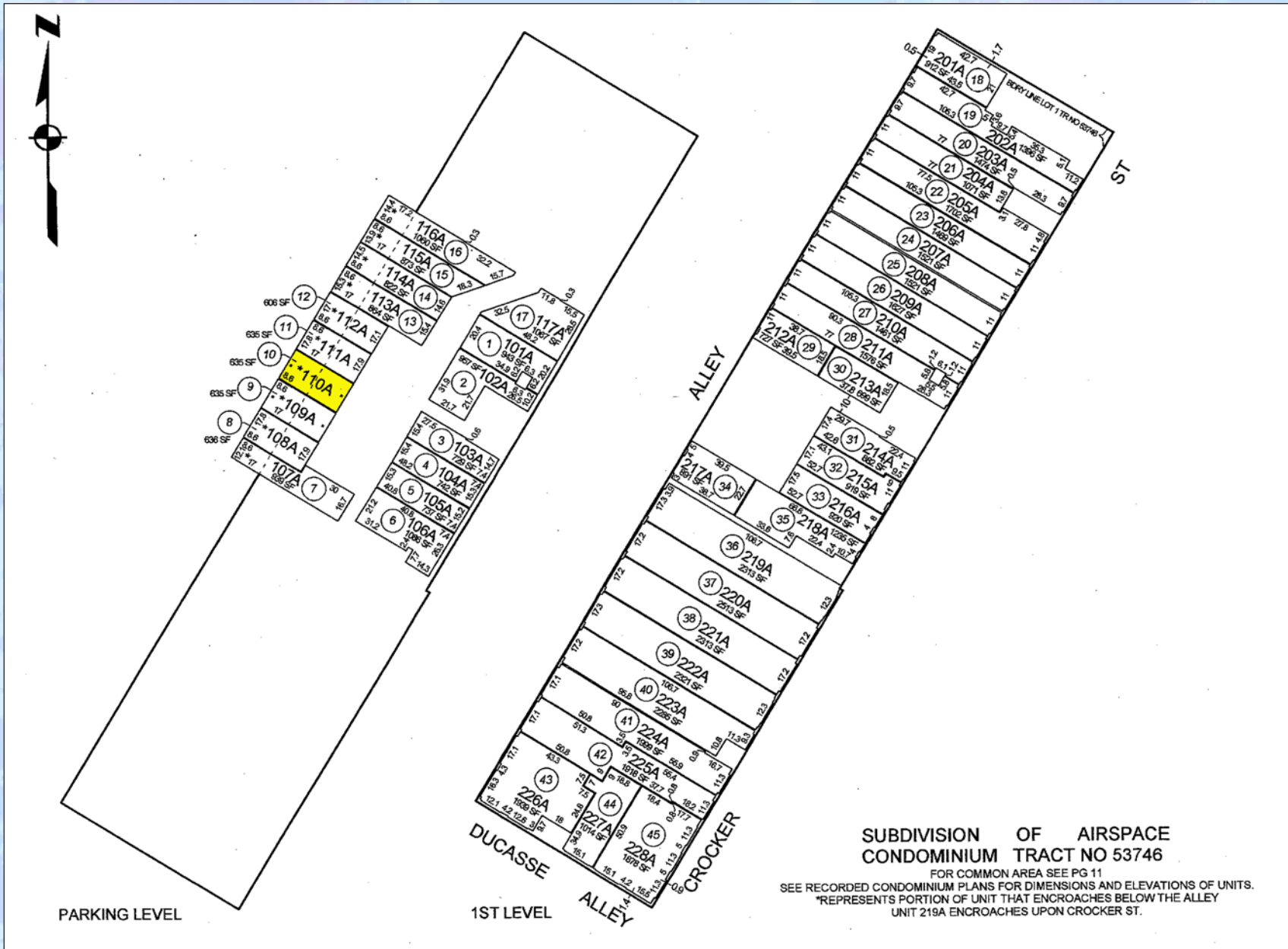

San Pedro Wholesale Mart Aerial Photo



Area Map

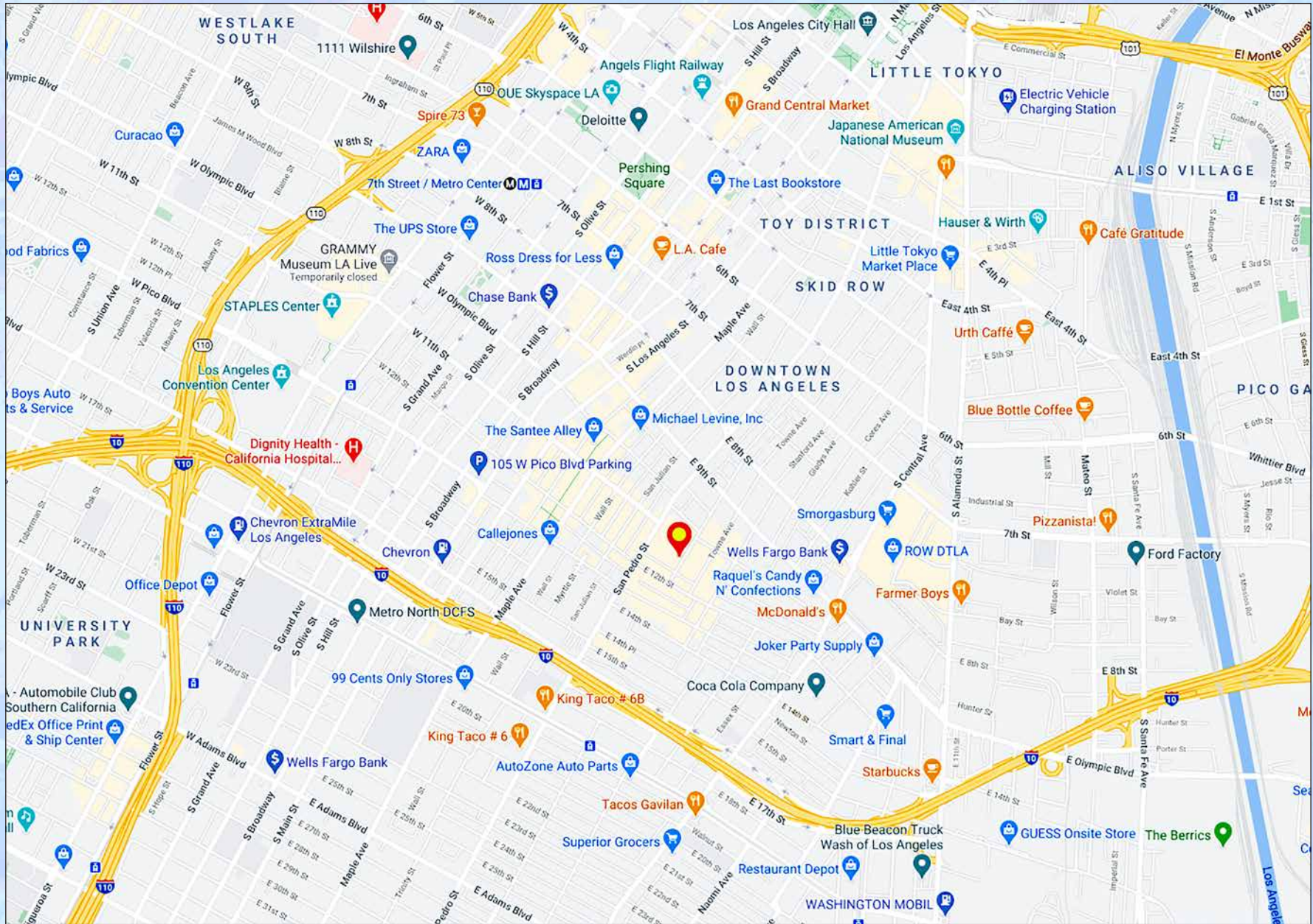

San Pedro Wholesale Mart

1015 Crocker Street, Unit P10
Los Angeles, CA 90021

635± SF Retail Condo
Part of Larger Property

Lowest Priced Condo in the Mart!
\$125,000 (\$196.85 Per SF)



Exclusively offered by

Sion Khakshour

Senior Associate

213.342.3384 office

213.210.7492 mobile

sion@majorproperties.com

Lic. 00697373

majorproperties.com

